

## Contact Details

Before using the product, please check the guide pages at the front of this catalog.

Internet

<https://www.daikinpmc.com/en/>

For latest information, PDF catalogs and operation manuals

# Direct Operated Relief Valve (for Remote Control)



## Features

- These valves are used for remotely controlling the pressure by connecting to the vent port of pilot operated pressure control valves such as relief valves and reducing valves.

## Nomenclature

※ - **JR** - ※ **02** - ※ - **22** - ※  
 1            2            3    4            5            6            7

### 1 Applicable fluid code

No designation: Petroleum-based hydraulic fluid, water-glycol hydraulic fluid  
 F: Phosphate ester hydraulic fluid

### 2 Model No.

JR: J series direct operated relief valve

### 3 Connections

G: Gasket mount type  
 T: Screw connection type

### 4 Nominal diameter

02: ¼

### 5 Pressure adjustment range

1: 0.8 to 7 MPa { 8 to 70 kgf/cm<sup>2</sup> }  
 3: 3.5 to 21 MPa {35 to 210 kgf/cm<sup>2</sup> }

### 6 Design No.

(The design No. is subject to change)

### 7 Option code

No designation: Pressure adjusting handle type  
 T: Pressure adjusting bolt type \*1

Note: \*1 The pressure adjusting bolt type is only applicable to the gasket mount type (G).

## Specifications

Model code	Nominal diameter	Pressure adjustment range MPa {kgf/cm <sup>2</sup> }	Maximum flow rate L/min	Mass kg
JR-G02-1-22	¼	0.8 to 7 { 8 to 70 }	1.2	1.5
JR-G02-3-22		3.5 to 21 {35 to 210 }		
JR-T02-1-22		0.8 to 7 { 8 to 70 }		
JR-T02-3-22		3.5 to 21 {35 to 210 }		

Model code	Pressure change MPa {kgf/cm <sup>2</sup> } per handle revolution
JR-※02-1	2.1 {21}/revolution
JR-※02-3	5.2 {52}/revolution

## Sub-plate model code

- The sub-plate is not provided with the valve. Order it separately as required by specifying the model code given in the table below.

Model code	Nominal diameter	Connection port diameter	Mass kg
JR-02M	¼	Rc¼	1.5

Refer to Page S-6 for the dimensions of the sub-plate.

## Accessories (gasket mount type)

Hexagon socket head cap bolt	Quantity	Tightening torque N·m {kgf·cm}
M8 × 25	4	25 to 30 {250 to 300}

## Handling

- Directly connect the tank piping of the valve to the tank without merging it with other tank piping.
- Since excessive internal volume of the pilot piping may lead to vibration, use steel pipes with an inner diameter of 4 mm maximum and with thick walls for this piping.

## Performance curves (viscosity: 32 mm<sup>2</sup>/s {cSt})

Flow rate - Pressure characteristics

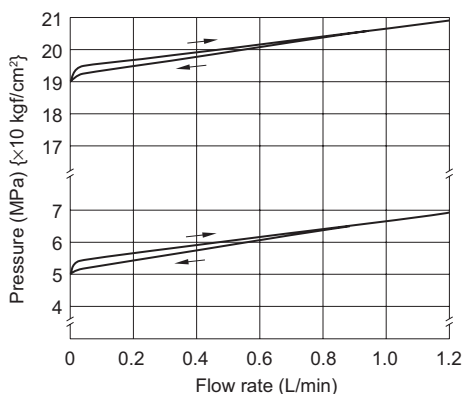

Pressure drop characteristics (with the handle fully open)

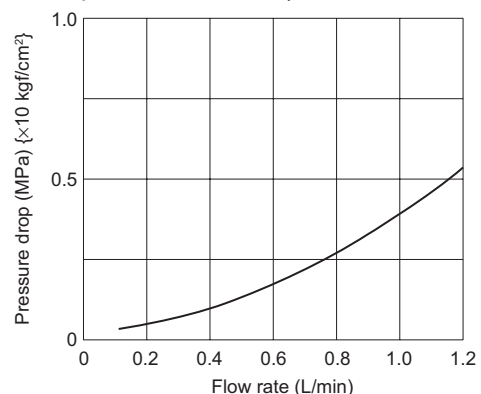

## Contact Details

Before using the product, please check the guide pages at the front of this catalog.

Internet

<https://www.daikinpmc.com/en/>

For latest information, PDF catalogs and operation manuals

## External dimension diagram

JR-G02

Pressure adjusting bolt type

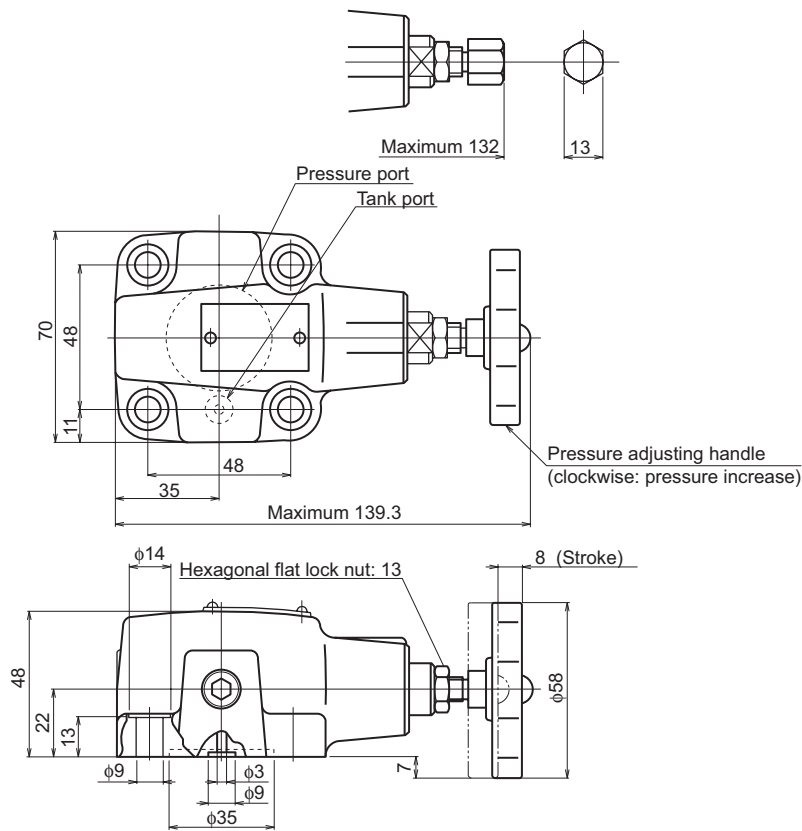

JR-T02

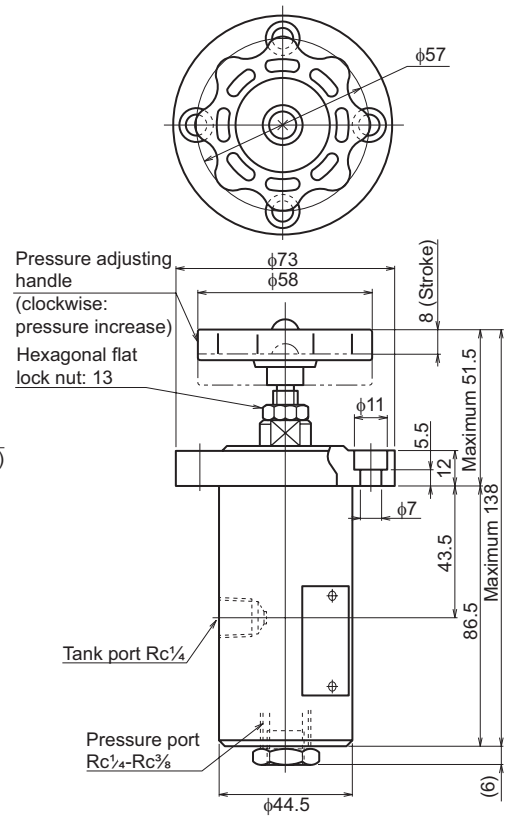

## Sectional structural diagram

JR-G02

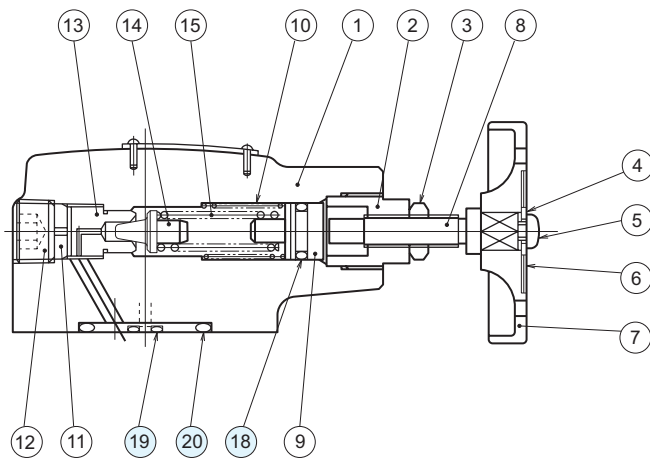

JR-T02

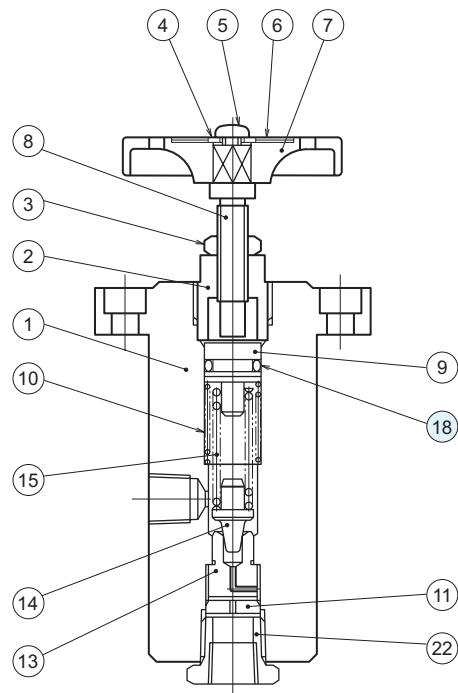

### Sealing part table

Part No.	Name	Quantity	Model/part specifications	
			JR-G02	JR-T02
18	O-ring	1	JIS B 2401 1AP11	JIS B 2401 1AP11
19	O-ring	1	JIS B 2401 1BP6	-
20	O-ring	1	JIS B 2401 1BG30	-