

Contact Details

Before using the product, please check the guide pages at the front of this catalog.

Internet

<https://www.daikinpmc.com/en/>

For latest information, PDF catalogs and operation manuals

Sectional structural diagram

MR-04P

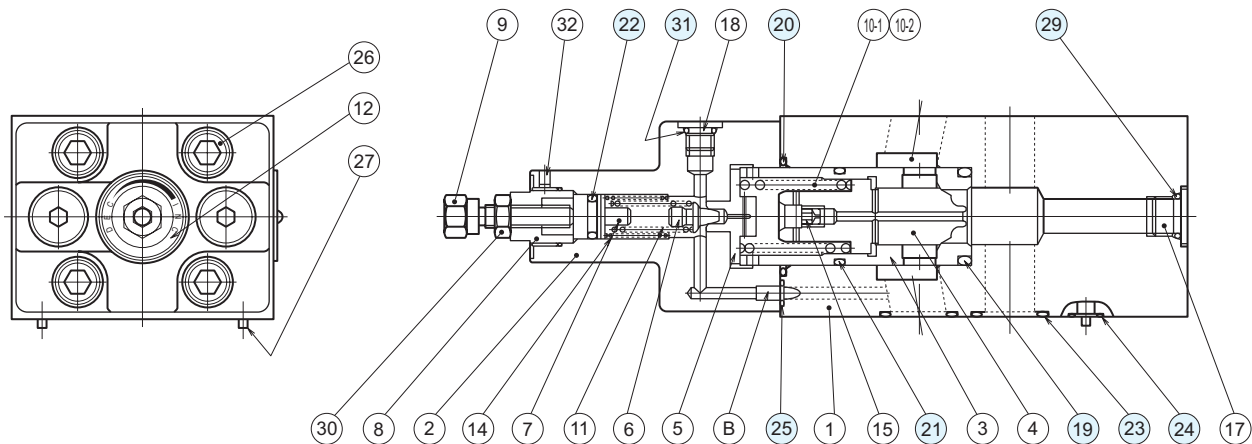

Sealing part table

Part No.	Name	Quantity		Part specifications
		-S02	-R02	
19	O-ring	1	1	JIS B 2401 1B P28
20	O-ring	1	1	AS568-127 (NBR, Hs90)
21	O-ring	1	1	AS568-122 (NBR, Hs90)
22	O-ring	1	1	JIS B 2401 1A P11
23	O-ring	4	4	AS568-118 (NBR, Hs90)
24	O-ring	2	2	AS568-012 (NBR, Hs90)
25	O-ring	1	1	JIS B 2401 1B P6
29	O-ring	3	-	JIS B 2401 1B P11
31	O-ring	2	2	JIS B 2401 1B P8

Drain type setting guide

- Either the internal or external drain type can be set by fitting/removing plugs.
To change the internal drain type to the external drain type, fit a plug (NPTF1/32) to port B and remove the plug (R $\frac{1}{4}$ plug for R02 or G $\frac{1}{4}$ hexagon socket thread plug with flange for S02) from the external drain port.

Tightening torque of NPTF1/32 hexagon socket taper thread plug:
0.9 to 1.2 N·m {9 to 12 kgf·cm}